

## TYPE: BLD-ACEXX03-0XYOS

LED Emergency Light Unique all-inclusive lamp, reflector, and lens assembly. Ultra-bright, energy efficient, long-life. White LED adjustable and movable heads. This design is great for placing in airport terminals, isles, restaurants, office buildings and warehouses.



### BLD-ACEXX03-0XYOS



#### SPECIFICATION

<b>TYPE</b>	BLD-ACEXX03-0XYOS
<b>WORKING VOLTAGE</b>	100-347V 50Hz/60Hz
<b>LUMEN</b>	356 Lm
<b>POWER</b>	3W
<b>CCT</b>	5000K
<b>RECHARGE TIME</b>	24 Hours
<b>EMERGENCY DURATION</b>	≥90 Mins
<b>BATTERY</b>	7.3V/2600mA
<b>FACTORY SETTING</b>	Standard / No Bluetooth
<b>ENVIRONMENT</b>	Damp
<b>WORKING TEMPERATURE</b>	5°C ~ 50°C
<b>CERTIFICATION</b>	UL
<b>FIRE RATING</b>	5VA
<b>CABLE</b>	Input Connect, No cable
<b>BLUETOOTH CONTROL</b>	Optional
<b>WARRANTY</b>	5 year limited

#### DIMENSION:

<b>WATTAGE</b>	BLD-ACEXX03-0XYOS
<b>NT. WEIGHT</b>	1.79 lbs(N.W)
<b>BOX DIM.</b>	11.00" x 6.25" x 3.14"(1Pcs/CTN )
<b>OUTER BOX</b>	13.58" x 12.0" x 16.53"(10Pcs/CTN )

## TYPE: BLD-ACEXX03-0XYOS

### ORDERING INFORMATION

EXAMPLE:

**BLD-ACEXX03-0XYOS**

<b>BLD</b>	<b>ACEXX03</b>	<b>0XYOS</b>
CODE	WATTAGE	FINISH
SB LED INC	03 (3W )	White

### ACCESSORIES (Standard)

### ACCESSORIES (SOLD SEPARATELY)



**Standard Installation Kit**

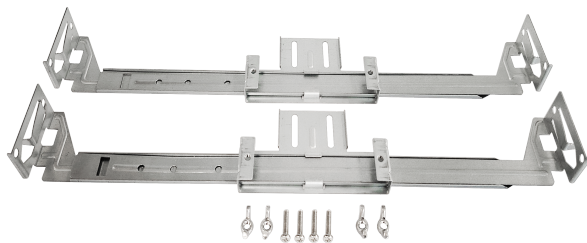

**BLD-ACEXX03-0XYOS-ZJ**  
Emergency Light Mounting  
Bracket Kit

### INDICATOR LIGHT INTRODUCTION

- ① Red/ON: Charging    ② Green/ON: Full-charged    ③ Indicator light OFF: Discharging(emergency mode)  
 ④ Green/Flashing: Self-testing    ⑤ Red Flashing:Error

**Note: See Trouble Shooting Guide**



Mode	LED Indicators Status	Error	EM Driver Status / Mode	Corrective Action
<b>Normal</b>	Solid Green	None	Battery fully charged/System OK	/
	Solid Red	None	Battery is charging	/
	Both LEDs OFF	None	In EM mode or emergency run-time is ended	/
	Flashing Green	None	Self-Diagnostic test underway	/
<b>Fault Mode</b>	Flashing Red	Battery	Battery not connected Battery failure	1.Check battery switch or connection. 2.Replace battery. 3.Contact after-sales.
	Flashing Red	LED Load		1. Check whether there are short circuits, damage, dimming wires connection wrong or loose. 2.Contact after-sales.

### MANUAL TEST

Test Mode	Description	Action	Status	Quit
<b>Fast Test</b>	Quick discharge test	Press the test button 1 time	LED load will flash for 5s	/
<b>Monthly</b>	30-second test	Press the test button 3s continuously	LED load will flash for 30s	Hold the test button/switch for 1s
<b>Annually</b>	90-minute test	Press the test button 6s continuously	LED load will flash for 90 minutes	Hold the test button/switch for 1s

## TYPE: BLD-ACEXX03-0XYOS

### Mounting Instructions

**NOTE: First turn off electricity.**

- 1** Remove the screw plug cover and the screws, then separate the lamp body (A) from the rear case (G).

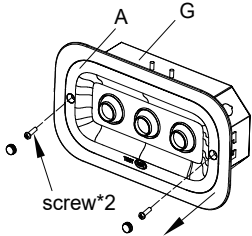

- 2** Knock off the rear cover (G) knock-off hole.(Spring installation, jump to step 7)

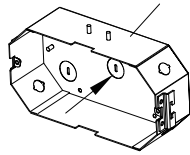

- 3** Mounting bracket: Not included (additional purchase required)

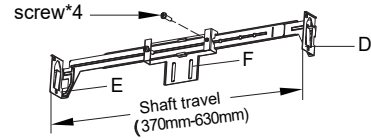

Measure the spacing of the cross beams. The supports B (D) and A (E) are fixed together through the support mounting plate (F). Position the support travel distance according to the cross beam spacing, and pre-lock two screws to fix one side. (Shaft travel 370mm-630mm).

- 4** The bracket is combined with the rear cover (G) and is fixed by locking 4 butterfly nuts.

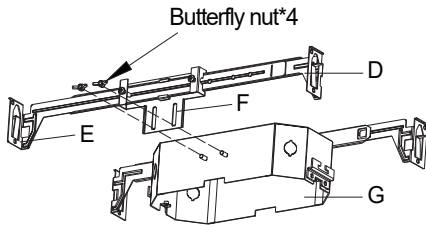

- 5** When the two ends of the bracket are pressed against the crossbeam, tighten the other two screws of the fixing plate (F) of the bracket. Hit the hooks at both ends of the bracket B(D) and bracket A(E) to fix them to the crossbeam, and then lock the 8 screws.

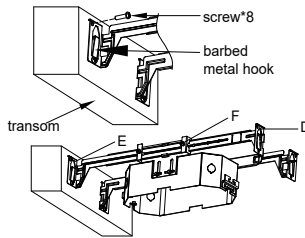

- 6** Connect the lines. Pass the wires through the knocked-out holes on the rear cover (G). Refer to "Step 8" for connecting the lines. -The lamp body (A) is inserted into the rear cover (G), fixed with screws, and then pressed into the screw plug cover. (The bracket installation is completed.)

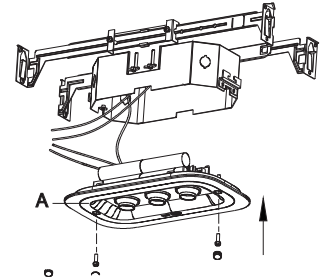

- 7** Spring mounting

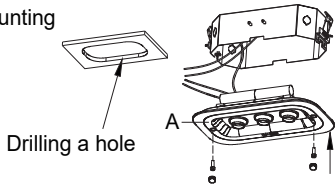

-Make a hole at the position of the opening card and reserve the power cable.  
-Connect the lines. Pass the wires through the wire hole in the rear cover (G). Refer to "Step 8" for connecting the lines.  
-The lamp body (A) is inserted into the rear cover (G), fixed with screws, and then pressed into the screw cap.

- 8** Connecting the wiring

-Use wire clips to connect the wires.  
-Use black and white wires. Connect the black power wire to the black fixture wire, and the white power wire to the white fixture wire.

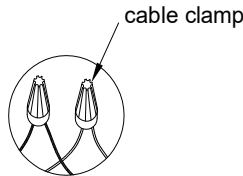

- 9** Press down on the spring and push the lamp into the hole. (The spring is installed successfully.)

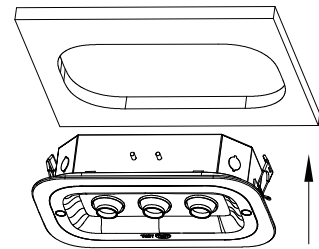

#### bracket mounting

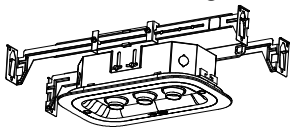

#### spring mounting

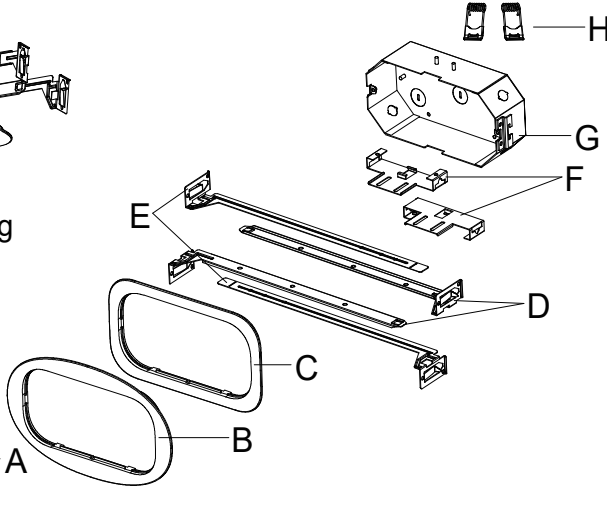
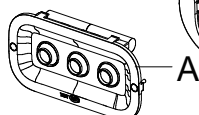
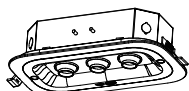

Part	Description	Quantity
A	Lamp body	1
B	Circular decorative panel	1
C	Square decorative panel	1
D	Bracket B (optional)	2
E	Bracket A (optional)	2
F	support plate (optional)	2
G	rear case	1
H	Spring	2