



## PLEASE READ ALL INSTRUCTIONS BEFORE ATTEMPTING INSTALLATION

- To prevent personal injury or product damage only licensed electricians should install.
- To avoid electric shock or component damage disconnect power before attempting installation or servicing.
- This product must be installed in accordance with the national electric code (NEC) and all applicable federal, state and local electric codes and safety standards.
- Disconnect product and allow cooling prior to servicing.
- Any alteration or modification of this product is expressly forbidden as it may cause serious personal injury, death, property damage and/or product malfunction.
- To prevent product malfunction and/or electrical shock this product must be properly grounded.
- This luminaire is designed to operate in ambient temperatures ranging from  $-30^{\circ}\text{C}$  to  $40^{\circ}\text{C}$  and to be horizontally mounted with the LEDs facing down.
- Wall Pack only.

## 1. Unpacking

Thoroughly inspect the fixture for freight damage. Freight damage should be reported to the delivery carrier.

## 2. Installation

- 1). Remove the lamp and hook from the mounting plate and fix the mounting plate and waterproof foam on the wall.
- 2). Hang the lamp on the mounting plate.
- 3). Connect the AC line of the lamp.

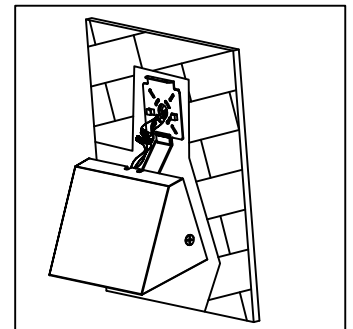
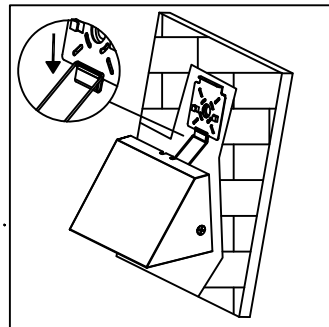
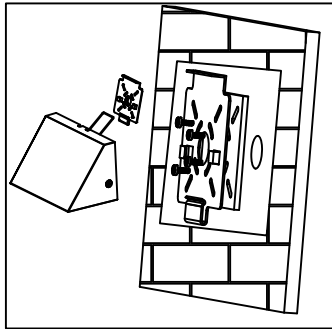

- 4). After hanging the lamp on the mounting plate and tightening the screws, And put a waterproof glue seal between the bottom cover and the wall to prevent water from entering the lamp.

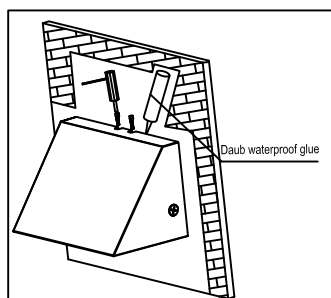

- 5). If the user feels that the light control probe exposed by the bulge of the lamp is not beautiful and does not need the light control function, you can unscrew the light control plug as shown in Figure A, pull out the probe black rubber plug inside the plug and put it back into the lamp to replace the spare flat plug and tighten, as shown in Figure B.

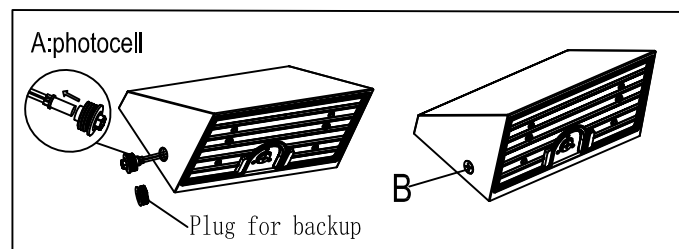

## 3. Junction box mounting

- 1). Install and secure the junction box and waterproof foam as shown in the figure.

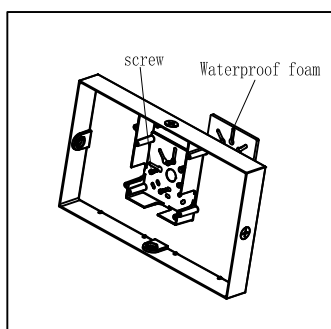

- 2). As shown in the figure, fix the mounting plate and the lamp mounting plate on the junction box in turn, and then hang the lamp hook on the mounting plate.

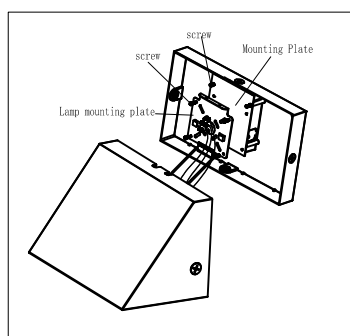

- 3). As shown in the figure, after the lamp screws are locked and fixed, the bottom box and the wall are sealed and waterproof with waterproof glue.

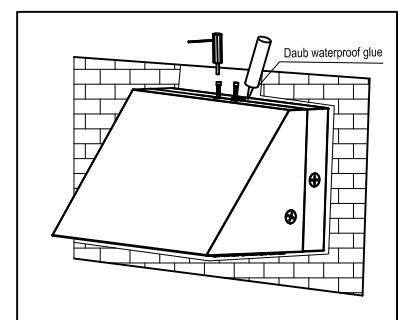

### CCT & Wattage Adjustable and Microwave installation instructions

A: photocell

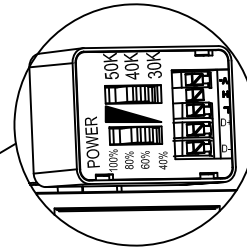
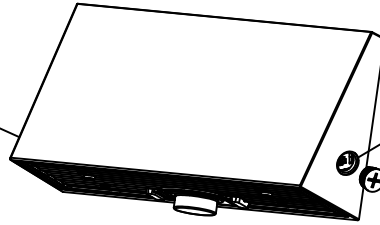
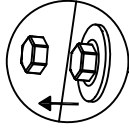

B: CCT & Wattage Adjustable

1) .If you need the light photocell function, remove the light control cover A.

2) .Like picture B, Unscrew the plug, adjust wattage and cct as desired, and tighten the plug .



3). As shown in picture, turn counterclockwise to unscrew the plug.

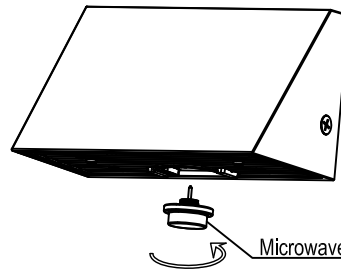

Microwave Sensor

4). Insert the microwave sensor into the hole and tighten it clockwise.

### General wiring Diagram

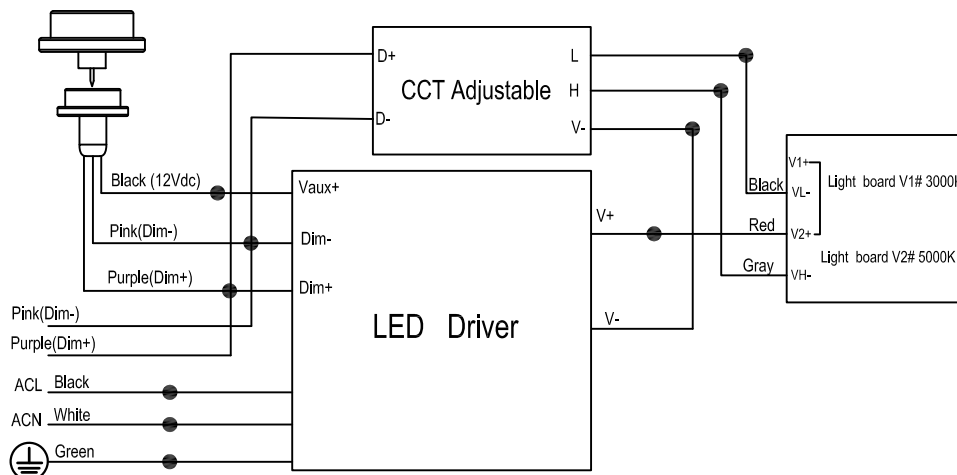

### 4. Checking

- 1). Does all the wires connect in a correct way as the pictures show below?
- 2). Is the ground lead installed appropriately?
- 3). make sure the photocell function well.