

Installation Instruction

WARNING

- To reduce the risk of death, personal injury or property damage from fire, electric shock, falling parts, cuts/abrasions, and other hazards read all warnings and instructions included with and on the fixture box and all fixture labels.
- Before installing, servicing, or performing routine maintenance upon this equipment, follow these general precautions.
- Commercial installation, service and maintenance of luminaires should be performed by a qualified licensed electrician.
- For the installation: If you are unsure about the installation or maintenance of the luminaires, consult a qualified licensed electrician and check your local electrical code.
- To prevent wiring damage or abrasion, do not expose wiring to edges of sheet metal or other sharp objects.
- Do not make or alter any open holes in an enclosure of wiring or electrical components during kit installation.

WARNING

- Turn off electrical power at fuse or circuit breaker box before wiring fixture to the power supply.
- Turn off the power when you perform any maintenance.
- Verify that supply voltage is correct by comparing it with the luminaire label information.
- All wiring connections should be capped with UL approved wire connectors.

CAUTION

- Avoid direct eye exposure to the light source while it is on.
- Account for small parts and destroy packing material, as these may be hazardous to children.
- Risk of burn. Disconnect power and allow fixture to cool before changing bulb or handling fixture.

NOTICE: Green ground screw provided in proper location. Do not relocate.

NOTICE: Minimum 90°C supply conductors.

NOTICE: Specifications and dimensions subject to change without notice.

NOTICE: Suitable for Dry or Damp location

General Wiring Diagram

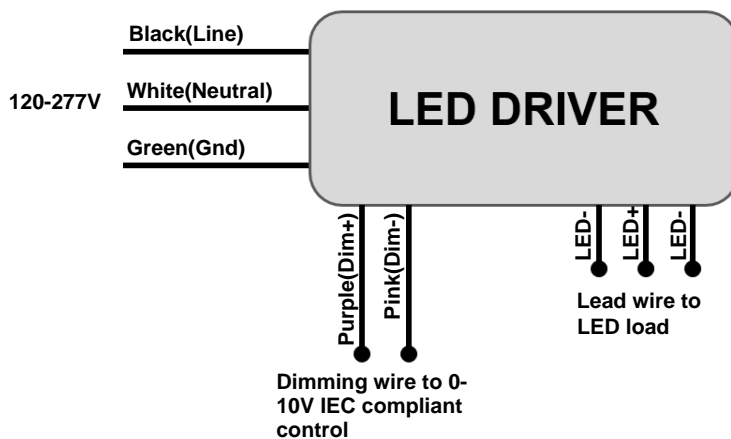

Installation Instruction

Surface mount to ceiling

Notice: Always turn off the power supply from main circuit breaker first!

Step 1: Open the flip-top on end-cap, remove the lens directly.

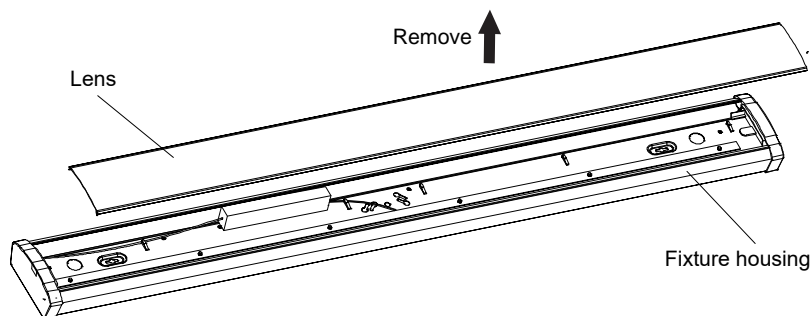

Figure 1

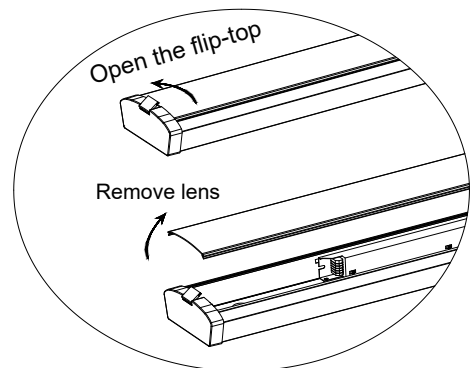

Figure 1A

Step 2: Place the luminaire on the junction box as a template, then mark the positions of 4 mounting holes in the ceiling.

Step 3: Put the luminaire aside and drill 4 mounting holes. Insert anchor into each hole.

Step 4: Make wiring in junction box (by others) refer to local Regulations and Codes. Attach the cover plate to the Junction box with screws (by others).

Step 5: Screw in the screws one by one to hang the fixture firmly.

Step 6: Reattach the lens.

- Insert whole lens slot onto one side-edge of housing.
- Carefully squeeze one end of the lens to engage opposite side-edge of the housing.
- Continue this action down length of the lens until it fully installed onto housing.

Step 7: Turn on the luminaire.

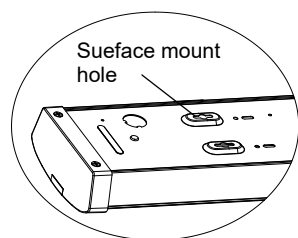

Figure 2A

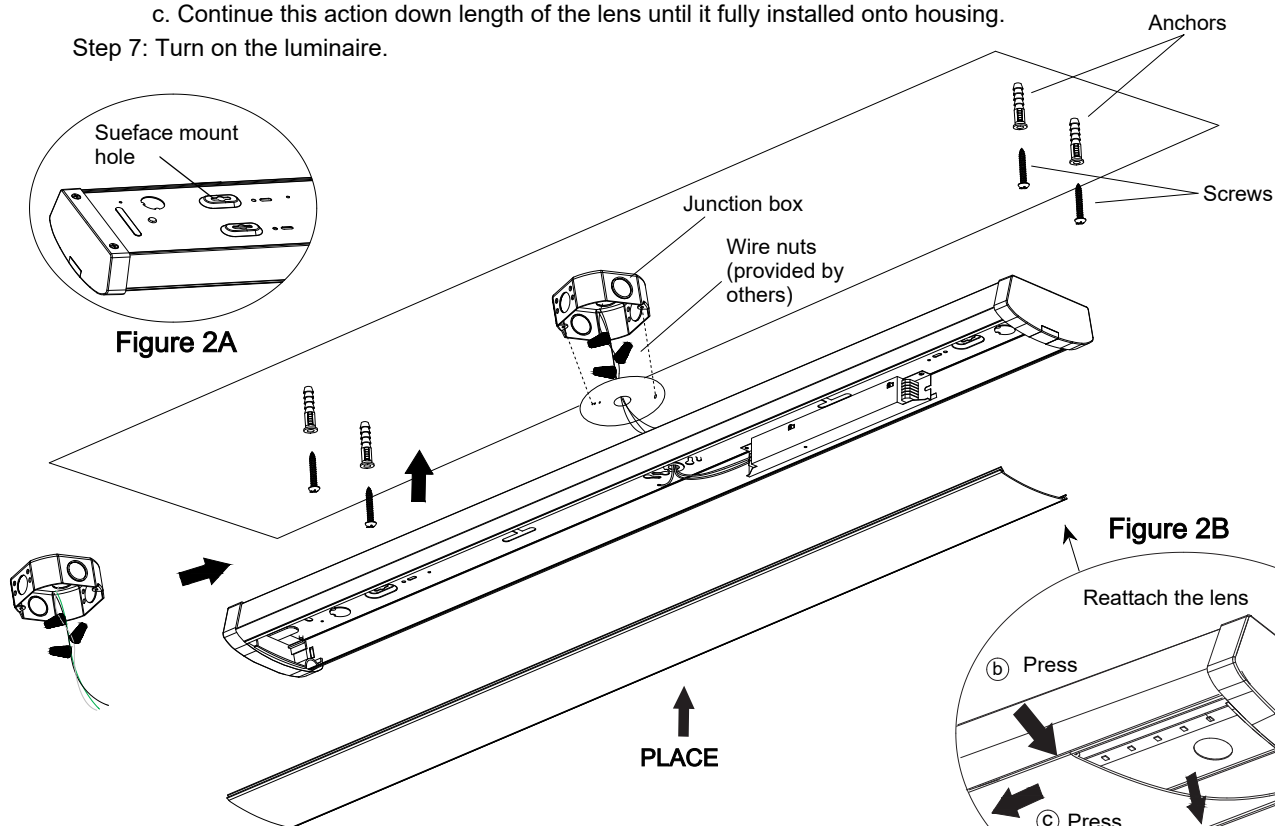

Figure 2

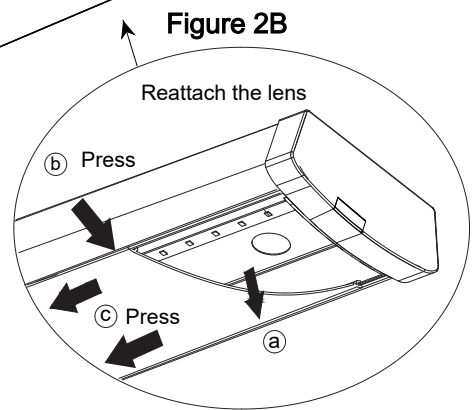
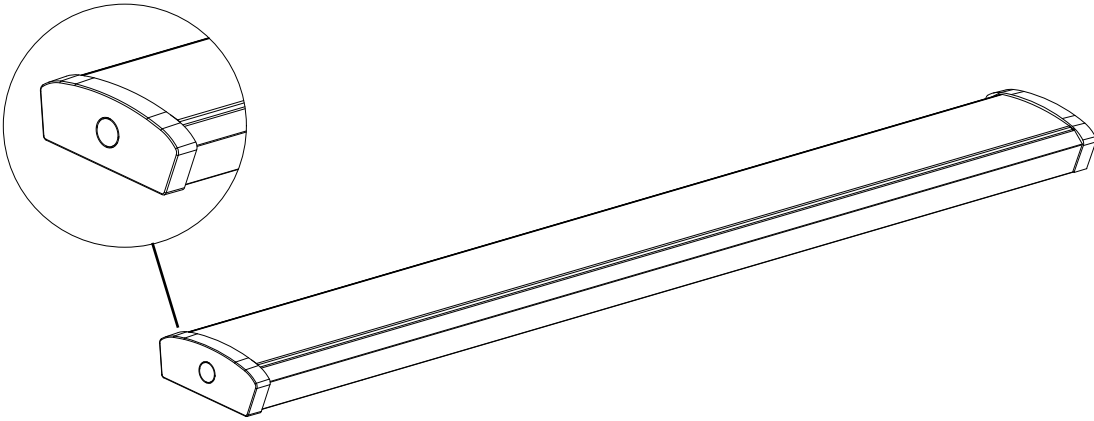

Figure 2B

Installation Instruction

End-cap with Knockout optional



Enhance the flexibility of wiring, daisy chain and installation.



Installation Instruction

Field-Adjustable Wattage & CCT

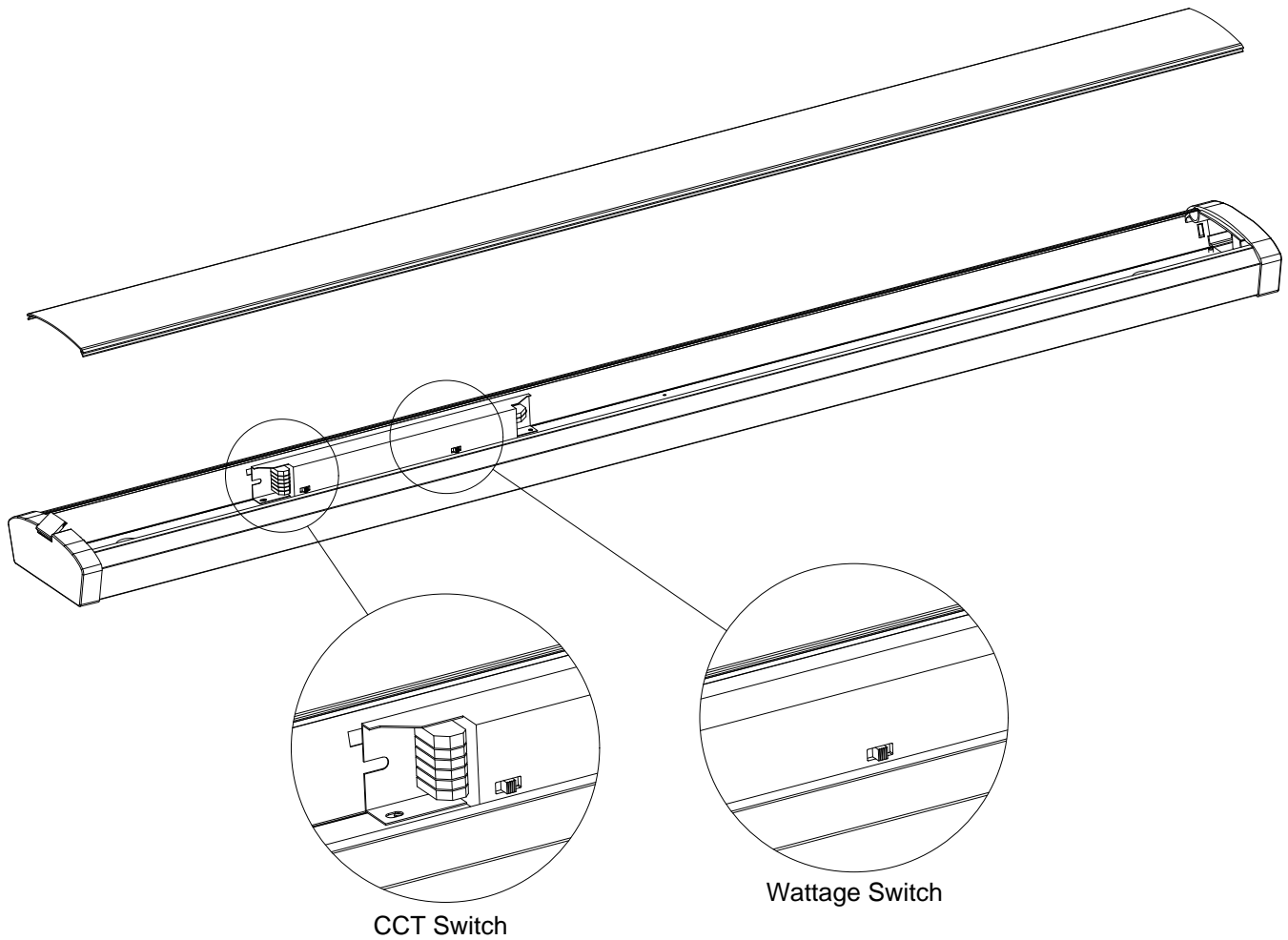

The end users may adjust the color temperature and lumen output respectively by the two DIP switches. CCT switch is accommodated with 5 CCT options (3000K, 3500K, 4000K, 5000K, 6500K), and Power switch is accommodated with 4 Power options. The switches can perform the desired color temperature and lumen output combination.

Select a wattage and color temperature by sliding switch left or right respectively to the desired value.

Installation Instruction

Additional Accessories

- DC12V Sensor

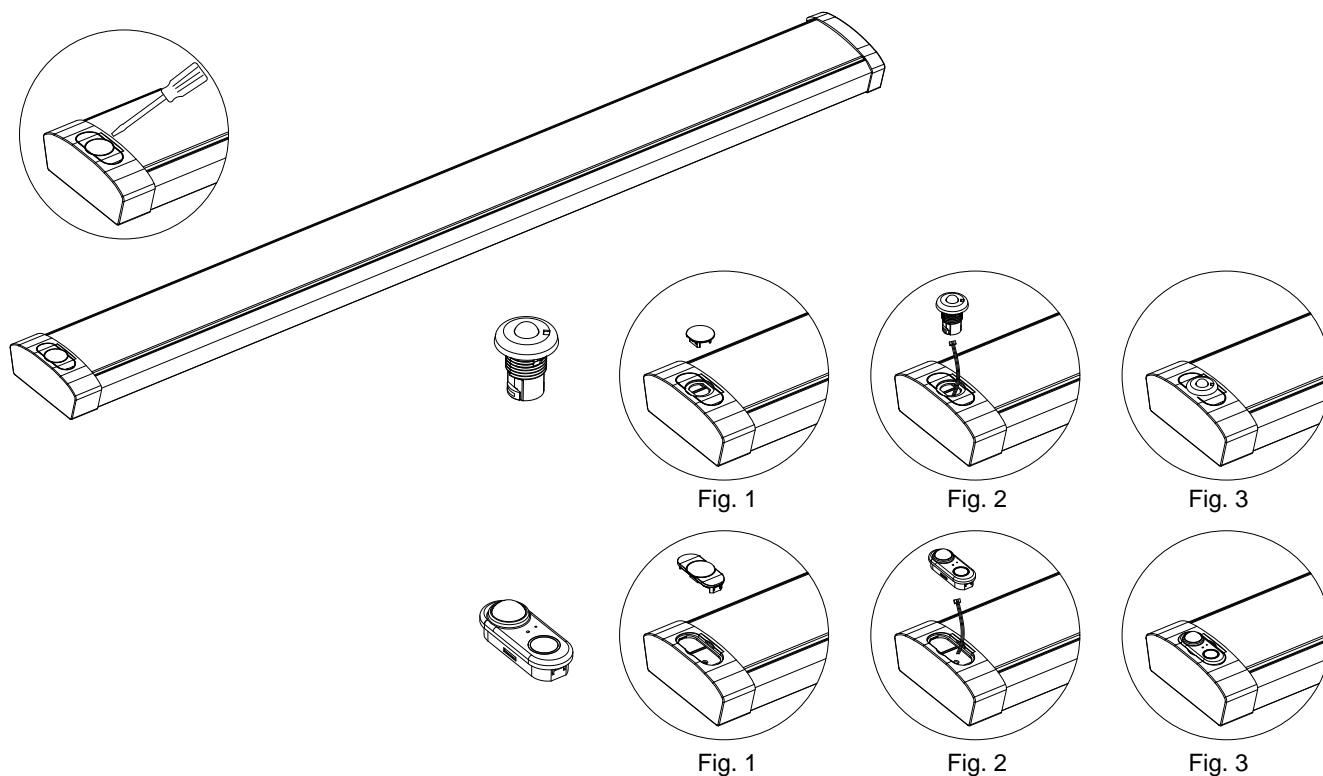

Step 1, Remove the sensor hole cover-plate before or after installing the fixture in the ceiling.(Fig. 1)

Step 2, Remove the flat cable that were secured on the back of the plate.

Step 3, Insert the terminals into the approved sensor. (Fig. 2)

Step 4, Install the approved sensor and make sure it is securely fit. (Fig. 3)

General Wiring Diagram

