

# DRAWING 1A

MODEL#	
PROJECT:	
NOTES:	
DATE:	
APPROVED BY:	
WEIGHT	
Pole: 54 LBS/PC	Anchor Bolt: 10.5 LBS/SET
Install Base Shield: 10 LBS/PC	Positioning Plate: 0.5 LBS/PC

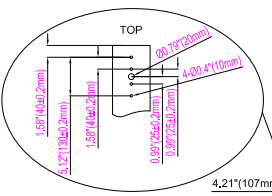

Add 4  $\phi 10$  and 1  $\phi 20$ mm holes respectively on all four sides of the light pole according to the marked size on the left .

M8 bolts are required for the top hole position, The fixed top movable adapter on all four sides are the same .

These three 10 and a 20MM hole are required Plug with a rubber plug to prevent water from entering each side .

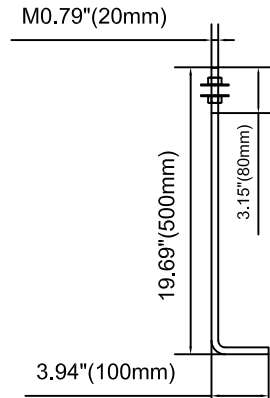
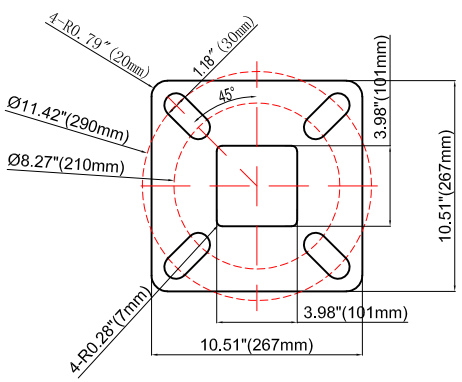
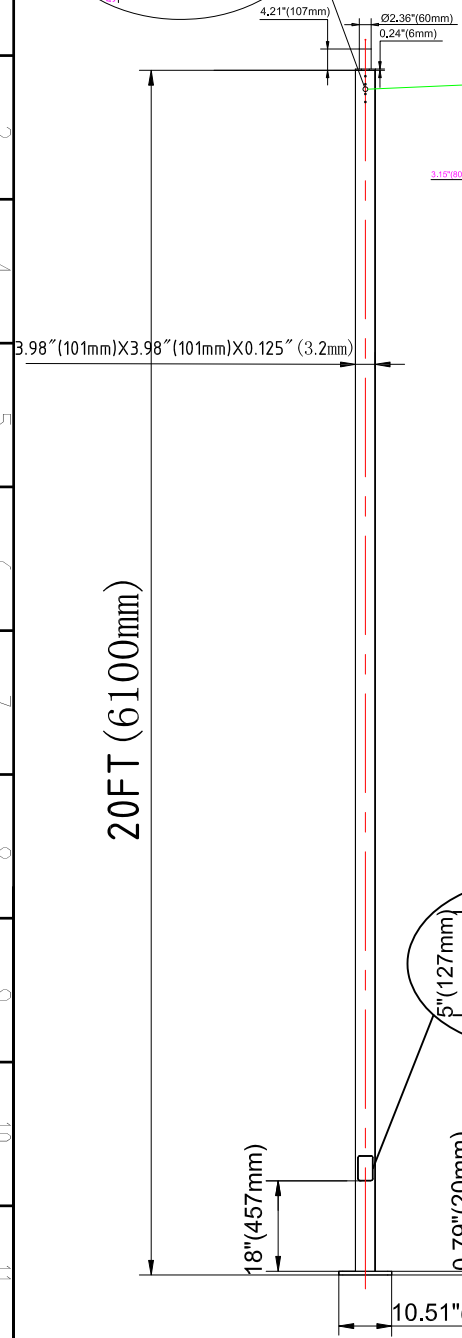

Model:WSD-BMS-S

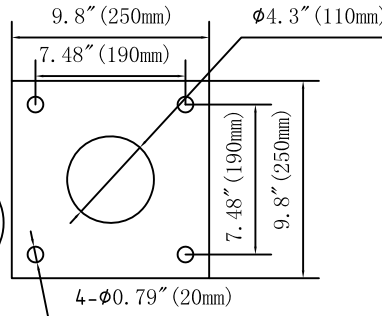

Model:WSD-SPP-D Position plate

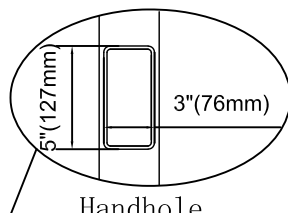
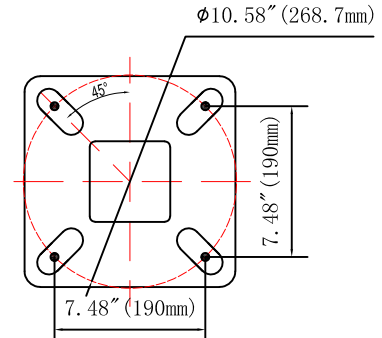

Handhole

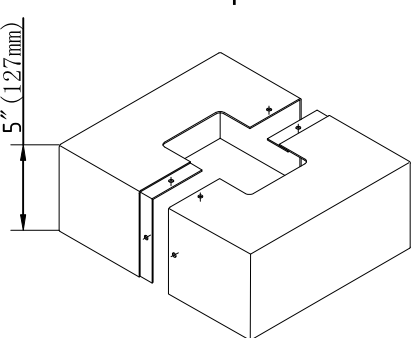

Model:WSD-IBS4-D

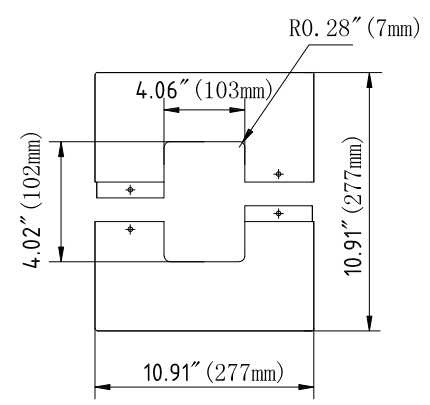

- Technical requirements
- Light pole material Aluminum alloy 6061-T6 and shall comply with ASTM F1554 class 55, the surface and inside of the light pole need to be oxidized and then the surface spray powder treatment, not according to 0.5MM chamfer..
  - All welding (electrode) shall be full, and there shall be no false welding, burr or other defects.
  - The unmarked tolerance shall be executed according to the common tolerance table.
  - Meet RoHS standards.

<p>WSD LED INC Green Lighting Resources</p>		edition		Modifier		Time of modification		Repair the interior		
		Material No.	312.0468	Edition	A/1	Page	1/1	Tolerance requirements:(tolerance without special requirements)		Date
		Material Name	WSD-SAL20FT4-125-D-T	proportion	1:1	Angle		NO ± 0.2	mapping	
Specification Description		unit	mm			.X ± 0.1	check			
Drawing Number		material quality				.XX ± 0.05	examine and verify			
						.XXX ± 0.015				