

BRI810-B Bi-Level & Daylight Harvest Motion Sensors

Fully adjustable high and low dimmed light levels;
Designed for LED fixtures; rated for extreme temperatures and up to 200,000 on/off cycles;

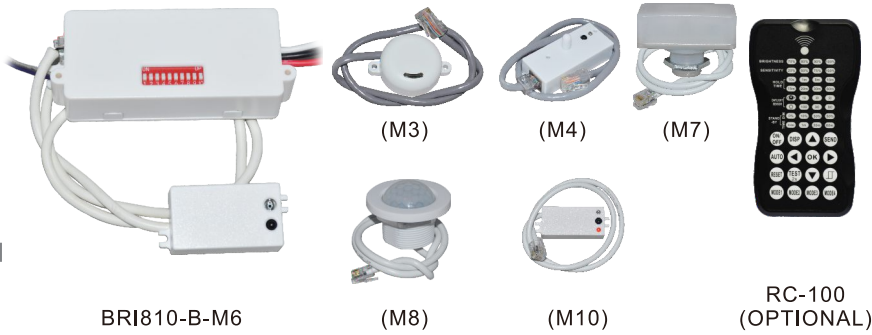

Adjustable via handheld wireless configuration tool;
Adjustable time delay and cut off delay;



PROJECT	
LOCATION/TYPE	

Product Overview

Description

BRI810-B is detached sensor with different sensor part from PIR to microwave sensor to meet different requests of the fixtures.

Daylight Harvest Function

This function inside the motion sensor to achieve tri-level control, for some areas which require a light change notice before switch-off. The sensor offers 3 levels of light: 100%-->dimmed light (natural light is insufficient)-->off; And 2 periods of selectable waiting time: motion hold-time and stand-by period; Selectable daylight threshold and freedom of detection area.



The light will not switch on when natural light is sufficient, even there is motion detected.

The light switches on automatically with presence when natural light is insufficient.

The light turns on at full or dims to maintain the lux level. The light output regulates according to the level of natural light available.



The light dims to stand-by period after hold-time and stays on selected minimum dimming level.



The light switches off completely after the stand-by period.

Features

- Provides line voltage On/Off switching and 0-10VDC dimming control
- Works with ballasts or LED drivers
- High and low modes fully adjustable from 0-10VDC
- Time delay from 10seconds to 60 minutes
- Optional cut off delay
- Adjustable ramp up and fade down times
- High inrush stability zero crossing circuitry for reliable, long-life operation catching relay is durable for all load
- Remote control
- UL773A and FCC

Specifications

Power supply	120-277VAC
Maximum load @ -40°F ~ 158°F (-40°C ~ 70°C)	Resistive/Tungsten - 600W@120V Electronic Ballast (LED) - 800VA@120V/1200VA/277V
HF System	5.8GHz ±75MHz
Dim control output	0-10V, max. 25mA sinking current
Detection radius/angle	Max 26ft.(8m)/360°
Mounting height	Max 40ft
Remote range	33ft. (10m) indoor, no backlight
Humidity	Max. 95% RH
Temperature	-40°F ~ 158°F (-40°C ~ 70°C)

Dimensions

BRI8-B-F power part

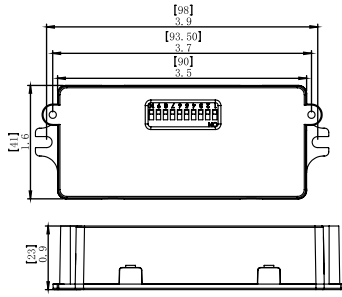

M3 MV sensor part

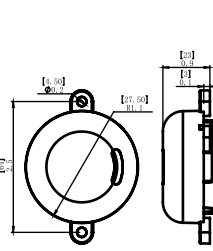

M4 MV sensor part

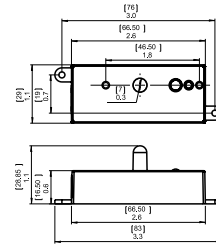

M6 MV sensor part

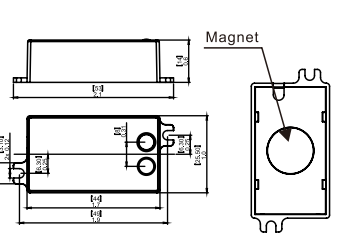

Coverage

M4, M10 sensor part (low bay)

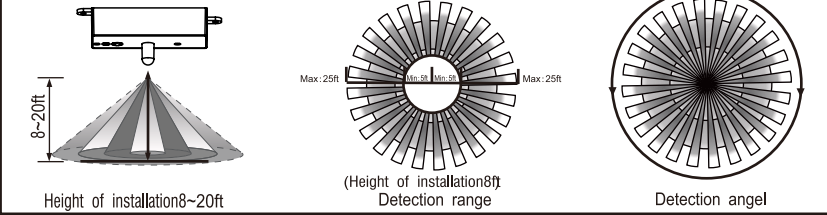

M7 MV sensor part IP65

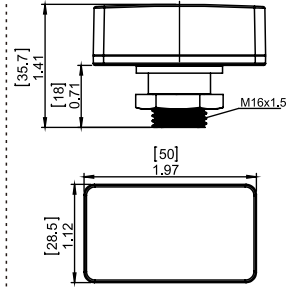

M3, M6, M7, M8 sensor part (high bay)

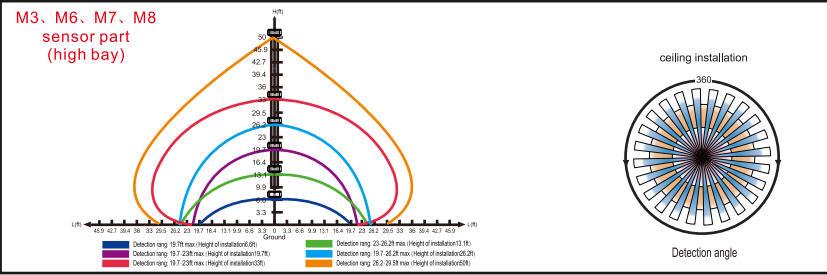

M8 PIR sensor part IP65

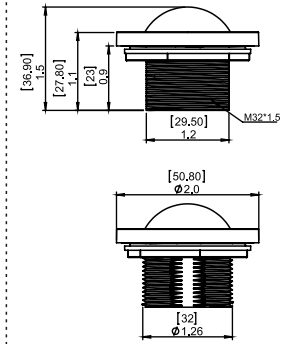

Wiring

Wiring with dimming ballast or LED driver.

Dimming Driver

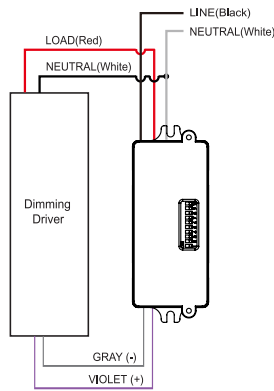

Wiring with non-dimming ballast or LED driver.

Non-Dimming Driver

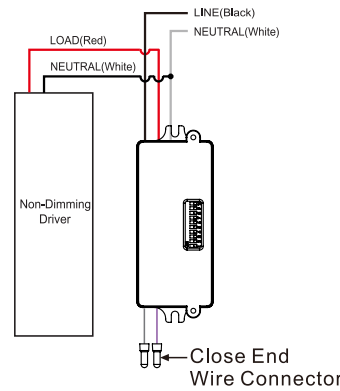

M10 MV sensor part

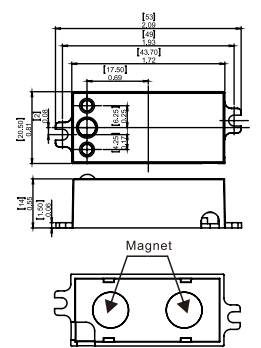

Ordering Information

Catalog No.	Color	Description
<input type="checkbox"/> BRI810-B-F	White	120-277Vac, Bi-level & Daylight Harvest function
<input type="checkbox"/> M3	White	Microwave sensor, maximum coverage 60' diameter from 8'-50' height
<input type="checkbox"/> M4	White	Microwave sensor, maximum coverage 48' diameter from 8'-20' height
<input type="checkbox"/> M6	White	Microwave sensor, maximum coverage 48' diameter from 8'-40' height
<input type="checkbox"/> M7	White	Microwave sensor, maximum coverage 48' diameter from 8'-40' height
<input type="checkbox"/> M8	White	PIR sensor, maximum coverage 48' diameter from 8'-40' height
<input type="checkbox"/> M10	White	Microwave sensor, maximum coverage 48' diameter from 8'-20' height
<input type="checkbox"/> RC-100	Black	Remote control Battery : AAA x 2