

25FT (7620mm)

1. This top should be equipped with the corresponding movable rubber plug cover to prevent rain from entering and easy to open for wiring .

2. According to the marked size on the left, measure 180 degrees on the face of the round pole 2 and add 5 hole positions respectively , the hole should be blocked with corresponding rubber plug to prevent rain from entering after opening the hole positions.

M0.79" (20mm)

3.15" (80mm)

19.69" (500mm)

3.94" (100mm)

Ø4" (102mm) X 0.12" (3mm)

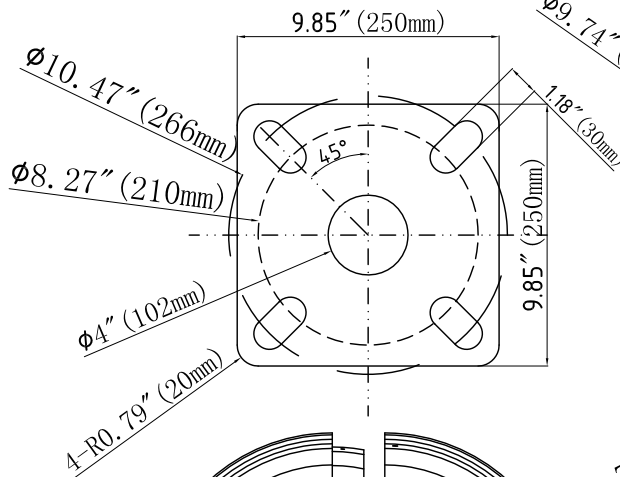

Ø9.74" (247.5mm)

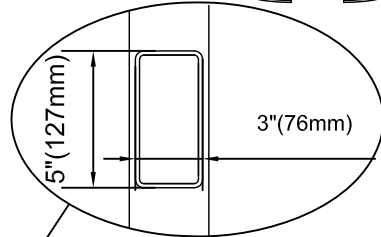
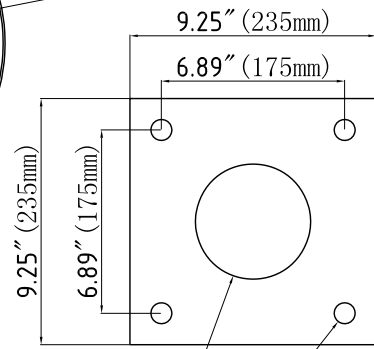
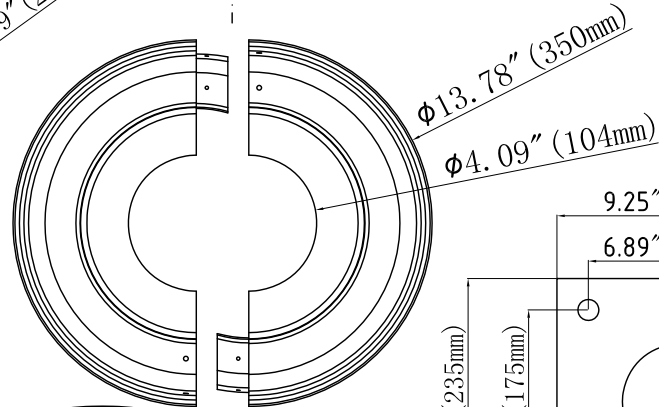
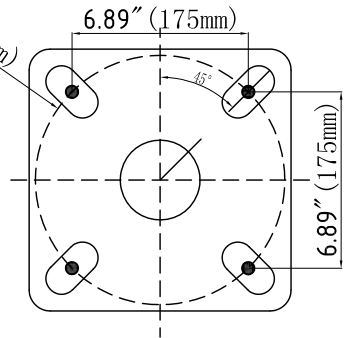

Handhole

The size of the base cover is a closed size .

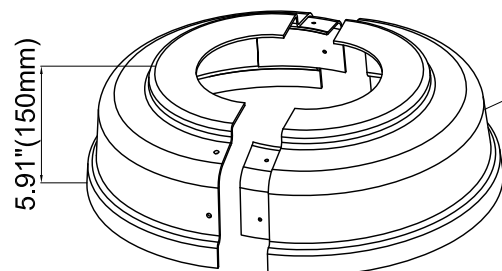

18" (457mm)

0.79" (20mm)

5.91" (150mm)

9.85" (250mm)

R25FT4-11G-D